

WWW.FUHR.DE

ALUMINIUM | STEEL

System solutions by FUHR

FUHR

ALUMINIUM | STEEL

System solutions by FUHR



Specially developed for cutting-edge projects.

Two materials. One comprehensive product range. A whole host of benefits.

The materials **ALUMINIUM** and **STEEL** are considered as trendsetters in door designs for both the non-residential and the private sector. This is why the expectations for new multipoint locking systems are particularly high.

FUHR, as a specialist in high-quality security systems, has responded to these expectations by addressing not only the consumer's need for greater convenience and security, but also – equally – the technical needs of door



fabricators. The result is an optimised, comprehensive, system-based product range offering a series of innovative technical features and optional accessories. The new product range will increase manufacturing efficiency for

fabricators, give them greater flexibility in their choice of components and allow them to respond more quickly to the needs of the market.

System solutions by FUHR. Quite simply a good idea.

Whichever components you choose, efficient production is guaranteed because the cut-outs and screw holes are identical for all products.



Same cut-outs and screw holes for all locking systems



Same cut-out even when an electric strike is used

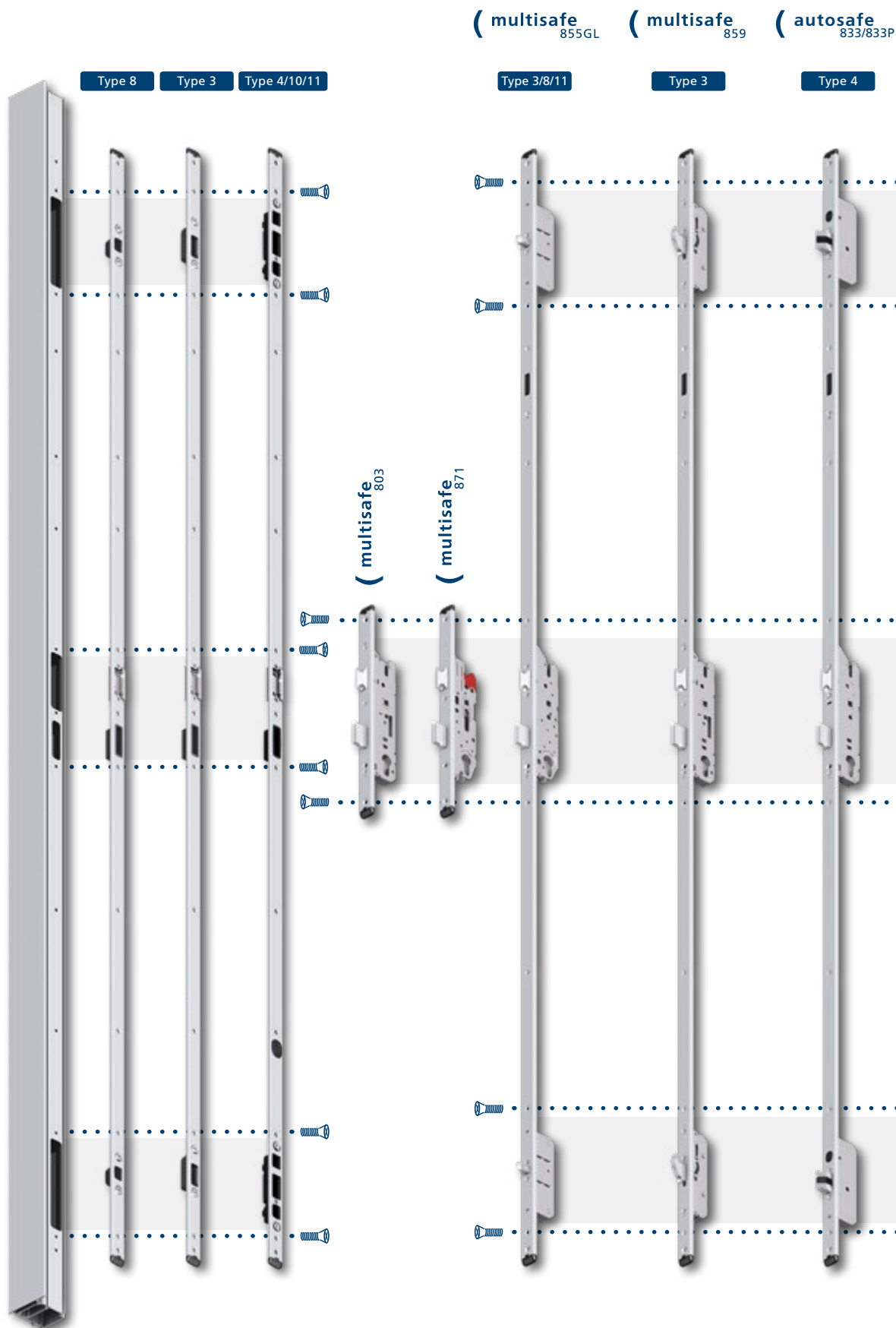

Benefits for you:

- ✓ Efficient manufacturing and warehousing
- ✓ Reliable production processes thanks to uniform components
- ✓ Flexible response to customer requests
- ✓ Durability due to high-quality materials
- ✓ All data relating to FUHR's range can be viewed using the widely used Orgadata LogiKal® metalworking software

(autotronic 834/834P (autosafe 835/835P (autotronic 836/836P (multisafe 870GL (multitronic 881GL

Type 4

Type 10

Type 10

Type 11

Type 11



Same cut-outs and screw holes for all locking systems and locks



Same profile cylinder axis for all locks

When it comes to meeting our customers' specific security needs, we've got a system.

Locking system	Type	Key operation	Lever operation	Automatic with deadlocking latch	Automatic with hook bolt	Motorised unlocking	Fully motorised	Panic EN 179/125	Day latch function	Access restriction lock	Switching contacts	For renovation purposes
multisafe 803	Mortise lock	●										
multisafe 871	Mortise lock	●						●				
multisafe 855GL	Type 3, 8, 11	●										
multisafe 855R	Type 3, 8, 11	●										●
multisafe 859	Type 3		●									
multisafe 870GL	Type 11	●						●				
autosafe 833	Type 4			●								
autosafe 833R	Type 4			●								●
autosafe 833SP	Type 4			●						●		
autosafe 833TF	Type 4			●					●			
autosafe 833P	Type 4			●				●				
autosafe 833PK	Type 4			●				●			●	
autosafe 833P – double-leaf	Type 4			●				●				
autosafe 833PK – double-leaf	Type 4			●				●			●	
autotronic 834	Type 4			●		●						
autotronic 834P	Type 4			●		●		●				
autotronic 834PK	Type 4			●		●		●			●	
autotronic 834P – double-leaf	Type 4			●		●		●				
autotronic 834PK – double-leaf	Type 4			●		●		●			●	
autosafe 835	Type 10				●							
autosafe 835SP	Type 10				●					●		
autosafe 835TF	Type 10				●				●			
autosafe 835P	Type 10				●			●				
autosafe 835PK	Type 10				●			●			●	
autosafe 835P – double-leaf	Type 10				●			●				
autosafe 835PK – double-leaf	Type 10				●			●			●	
autotronic 836	Type 10				●	●						
autotronic 836P	Type 10				●	●		●				
autotronic 836PK	Type 10				●	●		●			●	
autotronic 836P – double-leaf	Type 10				●	●		●				
autotronic 836PK – double-leaf	Type 10				●	●		●			●	
multitronic 881GL	Type 11						●	●				

Always prepared: we have a locking system for every door.

As a specialist in cutting-edge locking systems, FUHR has a solution to suit every conceivable security situation. Effective and proven components are available for this purpose. You can choose from a wide range of lock variants for use with aluminium and steel doors. The reliable security of the locking systems is documented, among other things, by the VdS approval. Our panic locks are also certified according to EN 179 and EN 1125 and are manufactured in fire-resistant designs as standard. They are therefore also well prepared for the most demanding requirements.



Type 8
Round bolt



Type 3
Hook bolt



VdS

Type 4
Automatic
deadlocking latch



VdS

Type 10
Automatic latching
hook bolts



VdS

Type 11
Hook bolt with
dual round bolts



VdS

Our best: FUHR multitronic 881.

The fully motorised multipoint locking system that sets the standards.



Convenience

Opening and closing takes place electronically – it seems to happen by itself. The door is unlocked via modern access control systems depending on personal preference.

Security

Premium quality materials, comprehensive testing and the compatibility with systems guarantee effective security, due to a long product life, lasting reliability and also the potential for integration into monitoring systems.

Energy

Multipoint locking every time ensures constant impermeability. The result: Precious energy is conserved, a comfortable environment is created and energy costs are reduced!

Accessibility according to DIN 18040

The fully motorised multipoint locking system **multitronic 881** makes buildings and rooms more accessible. Numerous equipment options always allow individual and comfortable operation, such as, for example, the integration of an electric swing door opener.



The standard version includes all system components in a set, ready to connect. When the door arrives on site, it merely has to be connected to a 230 V power supply.



FUHR multitronic 881 brochure

Contains full details and descriptions. Available to download at: www.fuhr.de

WWW.FUHR.DE

- ✓ Plug & Play
- ✓ All-inclusive set
- ✓ All components integrated in the door
- ✓ Functional tests complete

Radio access control systems.

A wide selection for individual convenience.

The FUHR comprehensive system-based product range for aluminium and steel doors also encompasses a wide range of state-of-the-art radio access control systems. They all have two things in common: outstanding convenience and dependability.



SmartConnect easy

Easy door opening and monitoring via smartphone. Intelligent access control system using Wi-Fi. Controls FUHR motorised locks, garage doors, electric strikes, roller shutters, lighting and much more.



SmartTouch comfort access system

No more searching for a key – the SmartKey in your pocket is enough. The KeylessGo feature provides keyless opening comfort by a simple touch on the stainless steel door handle. Alternatively also available as activation sensor.



Radio fingerprint scanner

Keyless biometric access control with 2-channel technology for opening of, for example, front door and garage. Designed to meet your requirements:

- **multiscan**
- **multiscan VdS** – for certified locking systems
- **multiscan go** – for comfortable programming by remote control



Radio transponder reader

Easy way of opening doors and garage doors via transponder that only needs to be held in front of the reader. Set consisting of 2 master and 3 user transponders. With 2-channel technology.



Radio keypad

Can open door and garage door via two individually programmable 4- to 8-digit codes. With separate button for a radio bell.



Radio key

Remote opening with 3- or 4-channel technology, for example of front door, side door, garage door and driveway gates.

FUHR multipoint locking systems – our security promise.

For 160 years, FUHR has been known for its unerring focus on quality. This experience allows us to offer products of outstanding technical maturity which are capable of meeting the very toughest requirements. The innovative, forward-looking range of FUHR products for aluminium and steel doors is no exception: it is technically diverse, extremely adaptable and ideal for integration into smooth, cost-effective assembly processes. The range was developed to ensure more security and convenience for users – and to ensure the success of your business.

Faceplates

- **Flat 24 mm:**
 - 2170 mm – low
 - 2170 mm – standard
 - 2400 mm – high
- **U 24 x 6 mm/U 24 x 6.7 mm:**
 - 1546 mm – low
 - 1790 mm – standard
 - 1990 mm – high
- Preconfigured for access restriction or additional bolt lock (833, 834, 835, 836, 855GL, 859 – standard and high)

Centre/follower

- 92 mm/8 mm
- 92 mm/9 mm – panic

Backsets

- 35, 40, 45, 55 mm
- Further backsets available on request

Finishes

- Ground stainless steel
- 855GL – type 3 and 833 – type 4 in standard length: FUHR-Silver also available

Screw holes

Countersunk for standard 4.2 mm window fabrication screw or FUHR M5 special self-tapping screw with small countersunk head

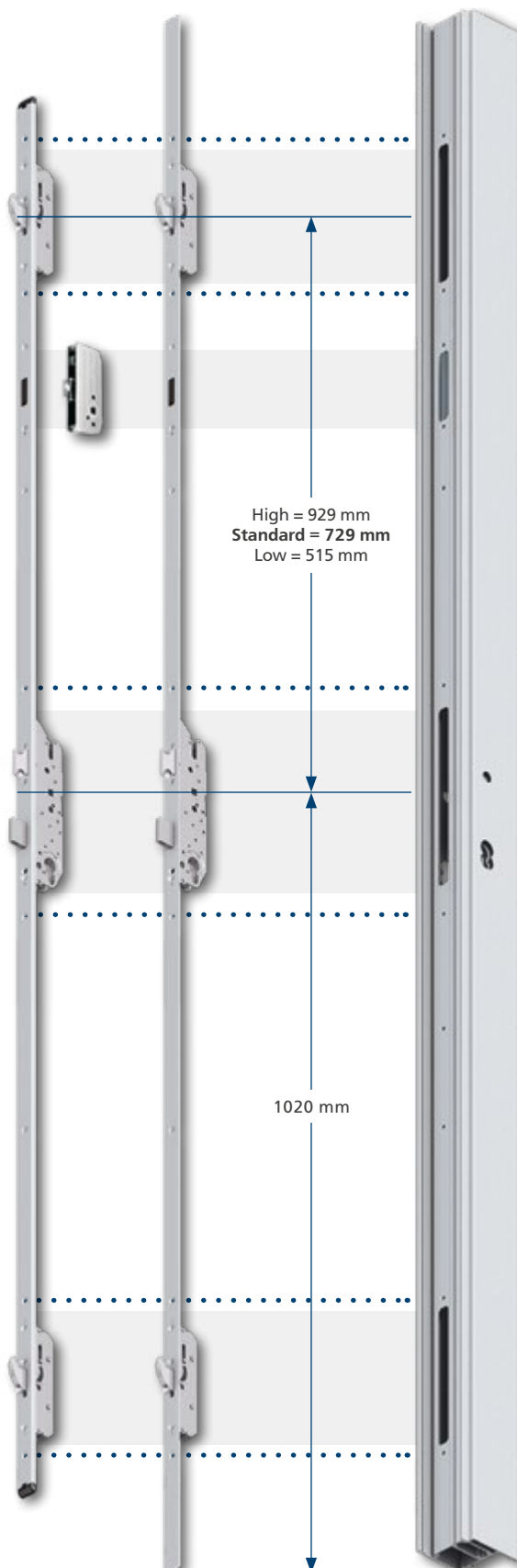

The system idea pays off. For security and convenience – and for your business.

Retrofittable accessories. Plenty of solutions, zero extra effort.



Access restriction lock
for 855GL. Restricts door opening, can be deactivated from the outside via the main lock



Access restriction lock
for 833, 834, 835, 836, 859. Restricts door opening, can only be operated from the inside



Additional deadbolt lock
to provide an additional deadbolt independent of the main lock



Roller latch
for 855GL, adjustable by up to 4.5 mm



Soft latch
for quieter closing of the door. Very durable



Day latch function
optional version of 833 and 835. Allows the deactivation of the automatic secondary bolts



Radio receiver module
for 834/836/881GL. For receiving a radio signal to open the door – with no need for a separate control unit

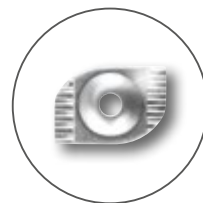

Clamping plate
for securing locks and standard or one-piece strike plates. Suitable for systems with the appropriate profile groove



Special self-tapping screw
Stainless steel, M5 x 12/15.4/25 mm, small countersunk head. For fitting locks and standard or one-piece strike plates

Extensions
Stainless steel, for door heights up to 4,000 mm, type 3 for 855GL/859, type 4 for 833(P)/834(P), type 8 for 855GL, type 10 for 835/836, type 11 for 855GL

Type 3 Type 8 Type 4/10/11

With integrated access restriction

Type 3 Type 8 Type 4/10/11

Without integrated access restriction



Type 4 magnet release
for system strike plates
type 4/10/11



Adjustable (+/-2 mm)
locking boxes, made
of coated metal



Type 10 magnet release
for system strike plates
type 4/10/11



Adjustable (+/-2 mm)
latch section



Contact magnet
for multitronic/
autotronic

Quality components from FUHR. Your profile deserves the best.

The FUHR comprehensive product range for aluminium and steel doors once again strikingly demonstrates the company's expertise in system-based solutions. Just three one-piece strike plates are enough to cover all locking systems. Needless to say, that also includes solutions featuring the high-performance motorised and automatic locks **multitronic** and **autotronic**.

FUHR one-piece strike plates

Widths

- Flat 24 mm
- U 24 x 5 mm

Lengths

- F = 1526/U = 1546 mm – low
- F = 1770/U = 1790 mm – standard
- F = 1970/U = 1990 mm – high

Finishes

- Ground stainless steel

Versions available

- Type 3
- Type 8
- Type 4/10/11 – preconfigured for contact magnet for use with FUHR motorised locks
- With integrated access restriction (standard and high)





Type 4/10 magnet release

for system strike plates
type 4/10/11



Access restriction and additional deadbolt adapter

for retrofitting

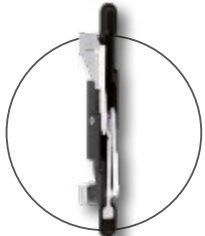

Flush bolt adapter

for retrofitting



Contact magnet

for multitronic/
autotronic



Adjustable (+/-2 mm)
locking boxes, made
of coated metal

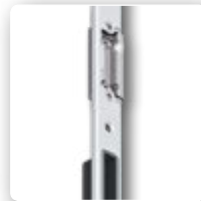

Adjustable (+/-2 mm)
latch section

Retrofittable one-piece strike plates for even greater flexibility

The **multisafe 844** one-piece strike plates have a modular design, making them suitable for use in a huge range of scenarios in single- and double-leaf aluminium or steel doors. They can be adapted to meet specialised security needs, for example, by adding an access restrictor. The unique adjustable latch section enhances draught-proofing and reduces assembly costs, because it eliminates the need to cut into the front edge of the profile. These strike plates testify once again to the efficiency of the new comprehensive product range by FUHR.

Technical details

Features

- With access restriction/additional deadbolt insert (standard and high)
- With flush bolt insert

Widths

- U 24 x 5 mm

Lengths

- 1546 mm – low
- 1790 mm – standard
- 1990 mm – high

Finishes

- Ground stainless steel

Versions available

- Type 3
- Type 8
- Type 4/10/11 – preconfigured for contact magnet for use with FUHR motorised locks

FUHR double door locking systems. End-to-end security.

The FUHR comprehensive product range for aluminium and steel doors is not only extremely reliable, but also very cost-effective. For example, as it is system-based, it can be used to create double door locking systems with virtually no extra effort. All that is needed is a few components in addition to the strike plates that you already have in stock.



The intelligent solution:

The flush bolt adapter turns the strike plate into a **multisafe 844** double door fitting.

Quality components from FUHR. Your profile deserves the best.

A selection of system relevant standard strike plates for selected locking types and optional accessories are also available.

FUHR standard strike plates

Widths

- Flat 24 mm
- U 24 x 5 mm
- U 22 x 5 mm
- U 22 x 8.5 mm
- U 24 x 8.5 mm

Lengths

- Latch/deadbolt strike plates: 212 mm
- Type 3 and 8 strike plates: 130 mm
- Type 4/10/11 strike plates: 220 mm
- Type 4 strike plates: 154 mm

Finishes

- Ground stainless steel
- Latch/deadbolt strike plates and type 3 and 4 strike plates also available in FUHR-Silver

Additional details

- Type 4/10/11 use the same base strike plate

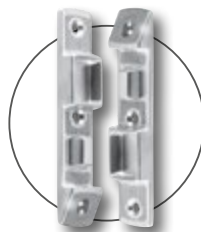

Dog bolts

Hinder removal of the door and enhance burglar resistance. Stainless steel. Supplied with 3 special self-tapping screws

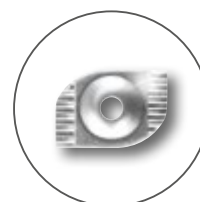

Clamping plate

for securing locks and standard or one-piece strike plates. Suitable for systems with the appropriate profile groove



Special self-tapping screw

Stainless steel, M5 x 12/15.4/25 mm, small countersunk head. For fitting locks and standard or one-piece strike plates



Type 4 magnet release

for type 4/10/11



Type 10 magnet release

for type 4/10/11



Type 3

Type 8

Type 4/10/11

Multifunctional frame components: technical perfection for maximum flexibility.



Latch slide

for use with FUHR electric strikes. Supplied in profile-specific designs



Electric strikes

Symmetrical, with radius latch and unique latch section. Can be used on right or left, available in a wide range of designs



Universal latch slide

Plastic, for outward-opening doors



Deadbolt switching contact

Strike plate contact for monitoring whether door is locked or unlocked, e.g. for connection to an alarm or building management system. Approved to VdS Class C, suitable for use with all FUHR standard and one-piece strike plates



Radio receiver for electric strikes

- Opens doors fitted with electric strikes remotely via radio signal
- Compatible with FUHR access control accessories
- Works with FUHR door strikes and all other standard door strikes
- Supplied with radio master key, uses highly secure rolling-code technology
- Compact design featuring stylish, slim, stainless steel cover
- Concealed or visible installation in door frame
- Ideal for retrofitting



FUHR double door locking systems. Espagnolette bolts and drive locks.



345K espagnolette bolts

Can be combined with standard strike plates or incorporated into a one-piece strike plate

- Flat 24/U 24 x 5 mm
- Various backsets available



Series 970-990 drive locks

for securing the inactive leaf

- Various versions and designs available



Optional accessories



Rod strike plates

adjustable for maximum draught-proofing

- Supplied in various profile-specific designs



Rod guide

with spring-loaded plain bearing for best possible rod guidance

- Low-noise rod guidance



Type 4

Type 10



FUHR solutions for emergency exit doors.

For when safe, reliable evacuation is needed – and fast.

FUHR offers a range of well-developed, certified locking systems with an integrated panic function for sophisticated double-leaf aluminium or steel doors. They work flawlessly in emergency situations to provide an absolutely reliable means of escape.

FUHR exit devices with an automatic multipoint locking system for double-leaf emergency and panic exit doors are the safe choice.

- **autosafe 833P/835P:** automatic panic exit system
- **autotronic 834P/836P:** features additional motorised unlocking

- ✓ Certified to EN 179 and EN 1125
- ✓ With panic keep, switching lock and self-locking shoot bolt for the second leaf
- ✓ Fire-resistant design
- ✓ Panic function B or E
- ✓ No freewheel cylinder required
- ✓ Optional with controlled latch locking (function E)
- ✓ Optional with switching contacts (833PK/834PK/835PK/836PK – function E)

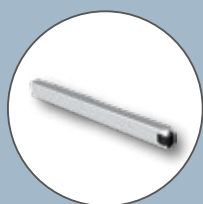

Carry bar

- For use on the right or the left
- For fitting on the inactive leaf
- Ground stainless steel



Panic fittings

Aluminium. Combination and lever handle sets for emergency exit doors in accordance with EN 179 or external hardware in accordance with EN 1125

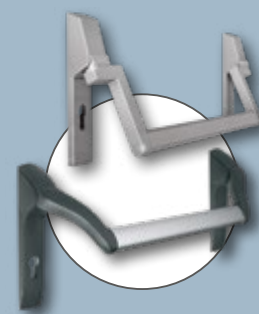

Panic bar hardware

Stainless steel or aluminium. For panic exit doors in accordance with EN 1125

For full details visit
www.fuhr.de

FUHR renovation lock range. Perfect for replacement and retrofitting.

Variable designs for flexible applications.

The FUHR renovation locks – the perfect replacement for existing multipoint locking systems for main and side entrance doors. Or to increase the security of doors with a mortise lock. Manufacturer independent.

With a three-part faceplate and toothed racks, the FUHR multipoint locks are ideally suited for replacement. They boast the typical FUHR quality characteristics: security, reliability, longevity.

Benefits for you:

- ✓ Multipoint locking system with 3-part faceplate and toothed racks
- ✓ Main lock case and faceplate can be ordered separately or assembled – for maximum flexibility
- ✓ Suitable as a replacement for almost any multipoint locking system – independent of the manufacturer
- ✓ Ideal for increasing the security of doors fitted with a mortise lock
- ✓ Flexible cutting options
- ✓ Easy to cut to the desired size
- ✓ Variable distance between main lock and secondary locks
- ✓ Freely selectable handle height
- ✓ Non-handed
- ✓ FUHR-Silver or stainless steel faceplate surface
- ✓ Wide range of designs

autosafe 833R

multisafe 855R



FUHR – expertise in locking systems for aluminium and steel doors.

Detailed information, convincing solutions.

Our comprehensive catalogue contains detailed information on and convincing solutions for our range of aluminium and steel doors. All presented in a practical way and designed to help you with your work. With detailed product descriptions, illustrations, drawings and ordering information. The catalogue is available for download at: www.fuhr.de



All images and details of products, dimensions and designs were accurate at the time of going to press. We reserve the right to make changes in the interest of technical progress. Claims relating to specific models or products cannot be asserted. We accept no liability for misprints.

Picture credit, page 13:
© Thomas Drexel/thomas-drexel@gmx.de
Architecture: Obel und Partner GbR, Freie Architekten BDA/www.obel-architekten.de

CARL FUHR GmbH & Co. KG
Locks and Hardware

Carl-Fuhr-Straße 12
42579 Heiligenhaus
Germany

Tel.: +49 2056 592-0
Fax: +49 2056 592-384

www.fuhr.de · info@fuhr.de

